

3048 MB VITO Fitting instruction

| | | | |
|-----------------------|--------|------------------------|--------|
| 1. Acrylicpart | | 2. Center bracket | 2 pcs |
| 3. Support bracket | 4 pcs | 4. Side bracket left | |
| 5. Side bracket right | | 6. Cover collar | 8 pcs |
| 7. cover hat | 4 pcs | 8. Rubber washer 6mm | 8 pcs |
| 9. Rubber washer 3mm | 4 pcs | 10. Screw M6x30mm | 4 pcs |
| 11. Nylok M6 | 16 pcs | 12. Washer 6,4 x 15 | 12 pcs |
| 13. Nut cover hat | 16 pcs | 14. Self tapping screw | 4 pcs |

1. Fit the center brackets on the acrylicpart as shown on the picture.

2. Align the sun visor centrally on roof, allowing approximately 55mm space between the window rubber and bottom edge of the centerbracket.

3. Mark bracket hole centres on roof for drilling. Drill 9mm holes on the roof.

4. Loosen the front of the interior headlining.

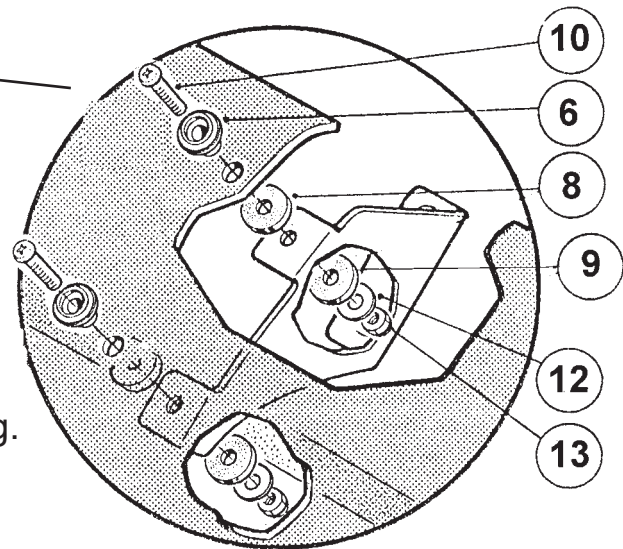

5. Place the support brackets into the cabin as shown. Tip: But some Sikaflex 252 on the bracket.



6. Put some sikaflex 252 on the roof to make sure water doesn't get in to the cabin.

7. Fit the sun visor by using 6mm washers, 6mm lylok nuts and nut cover hats.



8. Put 6mm rubber washers on the sidebracket screws and align pre-drilled hole in sun visor with side bracket.

9. Mark bracket hole on the door pillar and drill 3-3,5mm holes.

10. Fit side brackets on the door pillar by using selftapping screws.

11. Fit the side bracket on the acrylic part by using cover collars, 6mm nyloknuts and nut cover hats.

